

PLAT OF SURVEY

UNIT 20
SOUTH SHORE CLUB ON LAKE GENEVA
A CONDOMINIUM, ADDENDUM NO. 1

LOCATED IN CERTIFIED SURVEY MAP 2631
RECORDED IN VOL. 13 OF CERTIFIED SURVEYS
ON PAGE 171, AS DOCUMENT NUMBER 311927
BEING IN ALL 1/4'S OF NE 1/4 OF
SECTION 18, TOWN 1 NORTH, RANGE 17 EAST
WALWORTH COUNTY, WISCONSIN

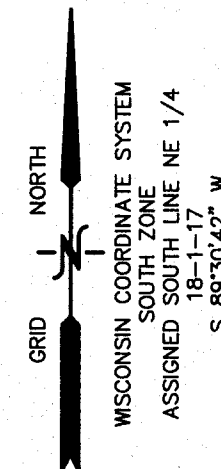

WORK ORDERED BY -
GENEVA LAKEFRONT REALTY
49 WEST GENEVA STREET
WILLIAMS BAY, WI.

FARRIS, HANSEN & ASSOCIATES, INC.
ENGINEERING - ARCHITECTURE - SURVEYING
7 RIDGWAY COURT P.O. BOX 437
ELKHORN, WISCONSIN 53121
OFFICE: (262) 723-2098 FAX: (262) 723-5886

REVISIONS

PROJECT NO.
4161.20
DATE:
04-13-2014
SHEET NO.
1 OF 1

LEGEND

△ = FOUND LANDSCAPE SPIKE

NOTE: COPIES OF THIS MAP TO WHICH THE FOLLOWING CERTIFICATE WILL APPLY SHOW SURVEYOR'S ORIGINAL SEAL AND SIGNATURE IN RED INK. COPIES BY ANY OTHER MEANS MAY HAVE ALTERATIONS WHICH DO NOT REPRESENT THE SURVEYOR'S WORK PRODUCT.

I HEREBY CERTIFY THAT THE ABOVE DESCRIBED PROPERTY HAS BEEN SURVEYED UNDER MY DIRECTION AND THAT THE ABOVE MAP IS A TRUE REPRESENTATION THEREOF AND SHOWS THE SIZE AND LOCATION OF THE PROPERTY, ITS EXTERIOR BOUNDARIES, THE LOCATION OF ALL VISIBLE STRUCTURES, AND DIMENSIONS OF ALL PRINCIPLE BUILDINGS THEREON, BOUNDARY FENCES, APPARENT EASEMENTS, ROADWAYS, AND VISIBLE ENCROACHMENTS, IF ANY. THIS SURVEY IS MADE FOR THE USE OF THE PRESENT OWNERS OF THE PROPERTY, AND ALSO THOSE WHO PURCHASE, MORTGAGE, OR GUARANTEE THE TITLE THERETO WITHIN ONE YEAR FROM THE DATE HEREOF.

DATED: MARCH 19, 2014

Peter S. Gordon
PETER S. GORDON R.L.S. 2101

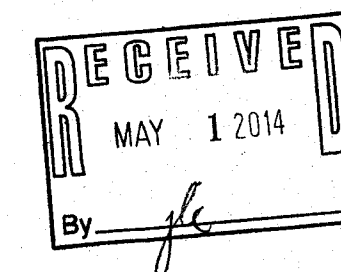
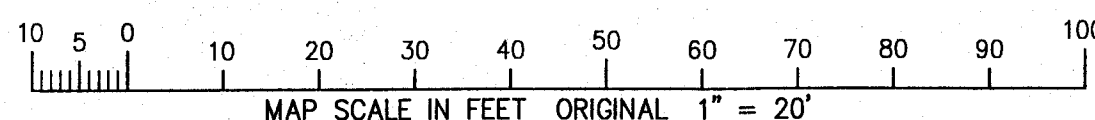

I88C -20

117-3647

APR 15 2014

4/15/2014 X:\Projects\4161\INDV\LOTS\Lot_20\doc\survey